

Ewald Park Design Options: Summary/Comparison

Program similarities:

- 20 parking spaces
- Playground and parkour equipment
- Two multipurpose courts (Tennis, Pickleball, Futsol)
- Accessible loop trail
- Picnic pavilion
- Potential restrooms
- Entrance plaza
- Fitness areas
- Seating

Program and design differences between Park Design Options 1 and 2

	Option 1	Option 2
Basketball Courts	2 basketball courts	1 basketball court
Parking	Parking largely remains as is, at existing location, with the addition of a one-way entrance.	Parking is relocated farther from a busy intersection, offering a more welcoming user experience by allowing visitors to view park activities from a vantage point. Additionally, Option 2 provides overflow parking spaces if needed.
Playground and Parkour	This option places the playground and parkour area in the southwest corner of the site at a higher elevation.	This option situates the playground near Duke Street at a lower elevation.
Open Lawn	This option offers a larger contiguous open lawn area with a loop trail	This option features more linear open space located along the southern side of the park, with some trail connectivity
Loop Trails	More loop trails	Less loop trails
Program/Amenities Placement	Programs and amenities are scatter across throughout the park.	Programs and amenities are clustered closer to Duke Street.

- **Option 1** includes two basketball courts, while **Option 2** features only one basketball court.
- **Option 1** parking largely remains as is, with the addition of a one-way entrance. **Option 2** relocates parking farther from a busy intersection, offering a more welcoming user experience by allowing visitors to view park activities from a vantage point. Additionally, **Option 2** provides overflow parking spaces if needed.
- **Option 1** places the playground and parkour area in the southwest corner of the site at a higher elevation, whereas **Option 2** situates the playground near Duke Street at a lower elevation.
- **Option 1** offers a significantly larger open lawn area, while **Option 2** features a smaller open space tucked into the southwest corner of the site.
- **Option 1** includes more loop trails compared to **Option 2**.
- **Option 1**, programs and amenities are scatter across throughout the park. In contrast, **Option 2** clusters programs and amenities closer to Duke Street.

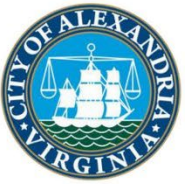

Ewald Park Design – Option 1

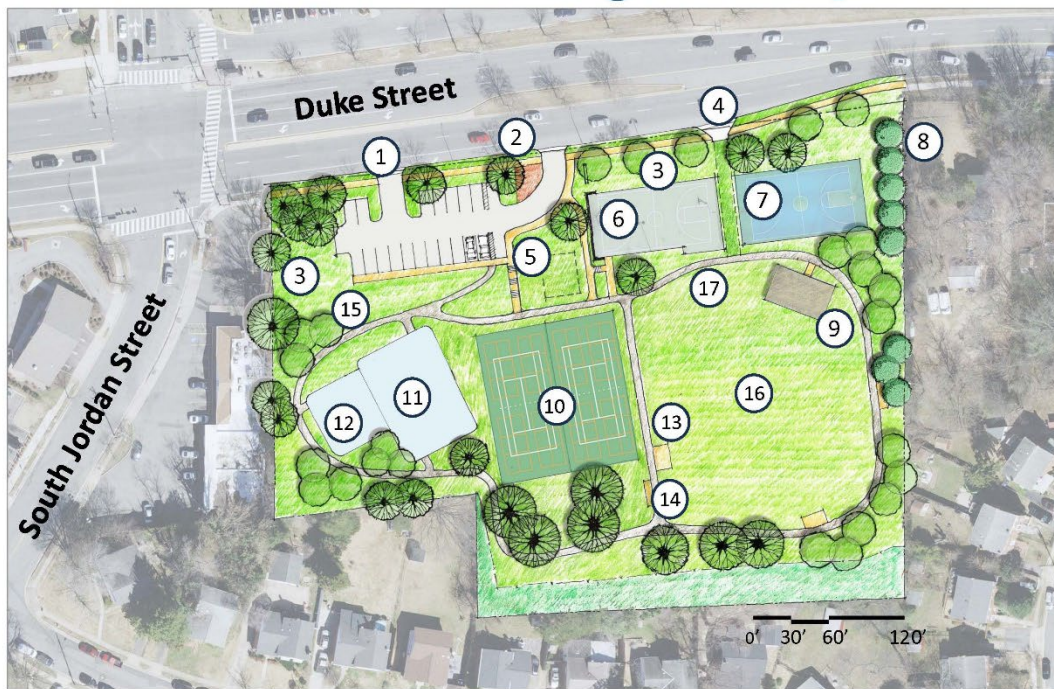

1. Proposed One-Way Vehicular Entrance
2. Park Entrance Plaza
3. Stormwater Management Systems
4. Park Maintenance Entrance
5. Restroom
6. Existing Basketball Court to Remain
7. Proposed Second Basketball Court
8. Vegetation Buffer
9. Picnic Pavilion
10. Two Multipurpose Courts
11. Relocated Playground
12. Parkour Fitness Area
13. Fitness Exercise Area
14. Seating
15. Slope Lawn
16. Open Lawn
17. Pathway system

Park Design - Option 1



Ewald Park Design – Option 2

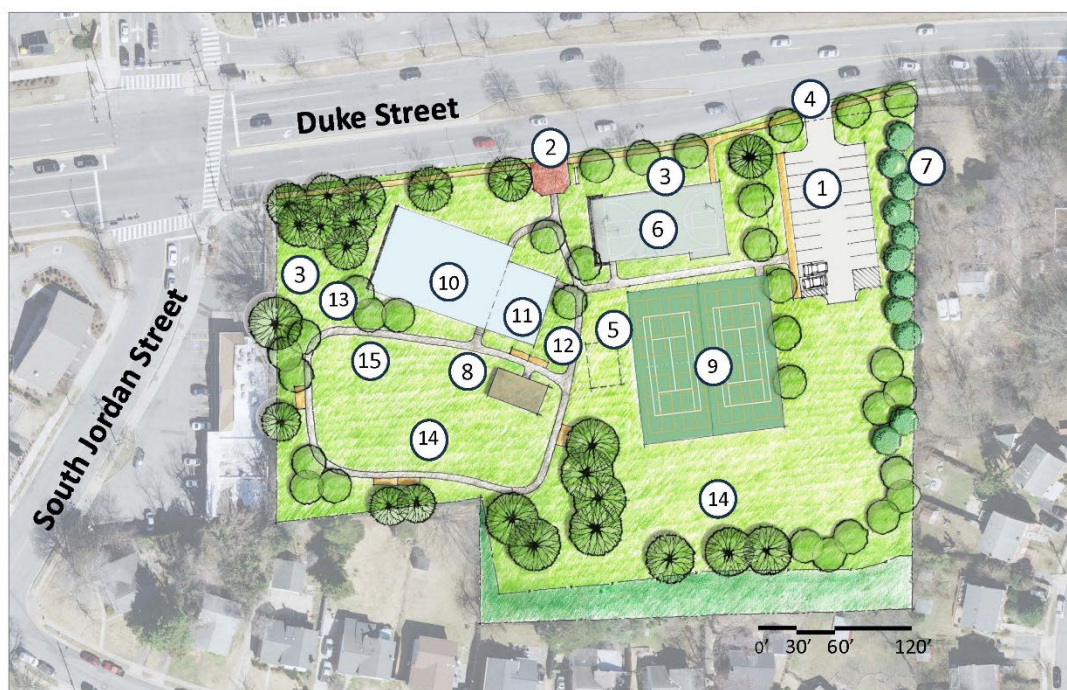

1. Relocated Parking Lot
2. Park Entrance Plaza
3. Stormwater Management Systems
4. Park Vehicular/Maintenance Entrance
5. Restroom
6. Existing Basketball Court to Remain
7. Vegetation Buffer
8. Picnic Pavilion
9. Two Multipurpose Courts
10. Relocated Playground
11. Parkour Equipment
12. Seating
13. Slope Lawn
14. Open Lawn
15. Pathway System

Park Design - Option 2